

MIKROMILL XL

T - Nutenfräsen

T - slot milling

Typ MA10.TS / MA12.TS / MA16.TS

T - Nutenfräsen

T - slot milling

Schneidkreis-Ø DS 12.5 - 32 mm
Nutbreite b 6 - 14 mm

cutting edge-Ø DS 12.5 - 32 mm
width of groove b 6 - 14 mm



MA....TS...R : Schrappprofil / roughing profile

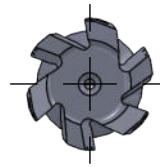
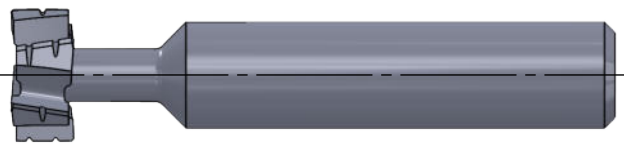

MA....TS...F : Schlichtprofil / finishing profile

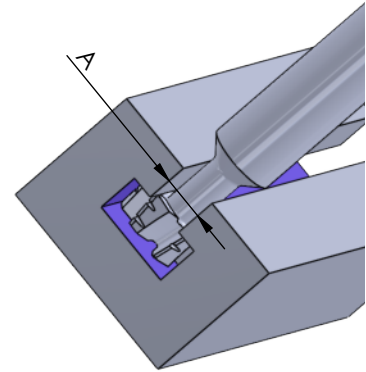
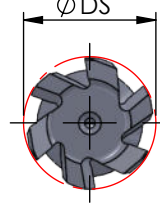
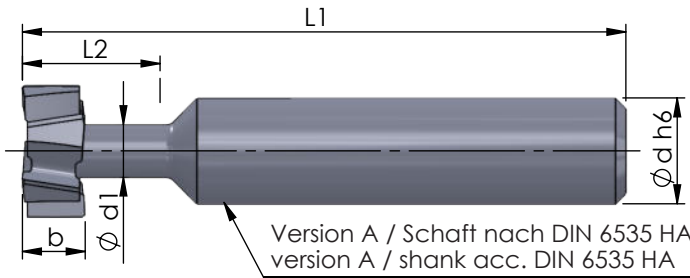

Abmessungen in mm

dimensions in mm



Bestellnummer part number	Schrappprofil roughing profile		Schlichtprofil finishing profile		Material			Schneidzahl cutting edge	Schrappprofil roughing profile	Schlichtprofil finishing profile	K10F	AL41F	P18C
	b d11	L2	L1	Ø d h6	Ø d1	A DIN 650	Ø DS d11						
MA10.TS06R-13	6	13	57	10	5	6	12.5	6	●				●
MA10.TS08R-16	8	16	62	10	7	8	16	6	●				●
MA12.TS08R-18	8	18	70	12	8	10	18	6	●				●
MA12.TS09R-21	9	21	74	12	10	12	21	6	●				●
MA16.TS11R-25	11	25	82	16	12	14	25	6	●				●
MA16.TS12R-28	12	28	85	16	13	(16)	28	6	●				●
MA16.TS14R-32	14	32	90	16	15	18	32	6	●				●
MA10.TS06F-13	6	13	57	10	5	6	12.5	6		●			●
MA10.TS08F-16	8	16	62	10	7	8	16	6		●			●
MA12.TS08F-18	8	18	70	12	8	10	18	6		●			●
MA12.TS09F-21	9	21	74	12	10	12	21	6		●			●
MA16.TS11F-25	11	25	82	16	12	14	25	6		●			●
MA16.TS12F-28	12	28	85	16	13	(16)	28	6		●			●
MA16.TS14F-32	14	32	90	16	15	18	32	6		●			●

Schrappfräser: max. Leistung, keine Anforderung an Oberfläche roughing cutter: max. roughing performance, no requirement on surface quality
 Schlichtfräser: wenn eine Anforderung an die Oberfläche besteht finishing cutter: high surface quality

Weitere HM Sorten können Sie in der Sortenübersicht im Kapitel "Technische Hinweise" und der Preisliste finden.

Bestellbeispiel:
für Sorte P18C:
MA10.TS06R-13/P18C

weitere Informationen:
• Nachschleifen ist 2 bis 3 mal möglich, in Abhängigkeit vom Verschleiß.

more informations:
• Regrinding is possible 2 to 3 times depending on wear.

More carbide grades you can find in the grades summary in the chapter "technical instructions" and in the price list.

order-example:
grade P18C:
MA10.TS06R-13/P18C